

ROAD MAP FOR HARRISON HOT SPRINGS

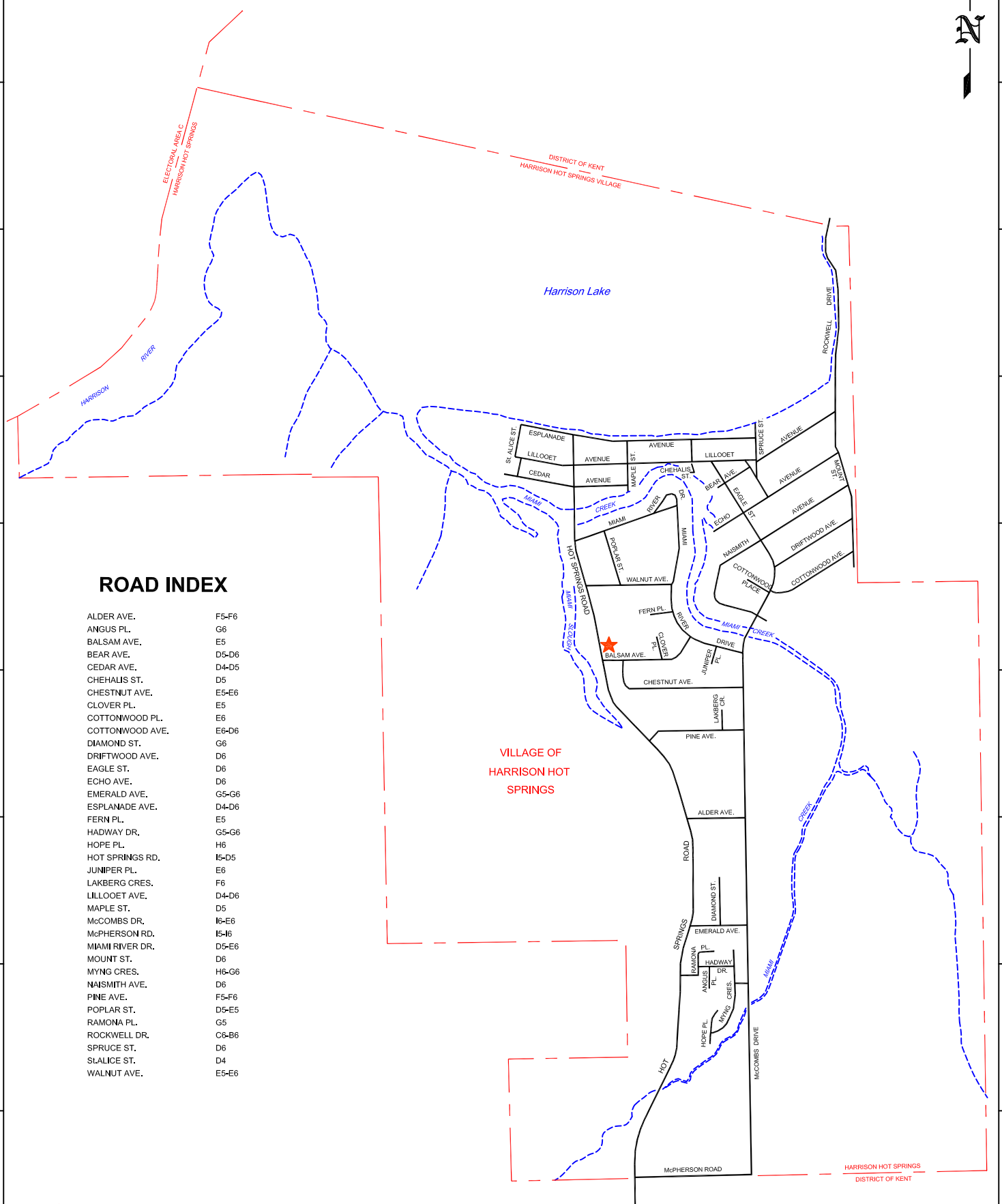

ROAD INDEX

ALDER AVE.	F5-F6
ANGUS PL.	G6
BALSAM AVE.	E5
BEAR AVE.	D5-D6
CEDAR AVE.	D4-D5
CHEHALIS ST.	D5
CHESTNUT AVE.	E5-E6
CLOVER PL.	E5
COTTONWOOD PL.	E6
COTTONWOOD AVE.	E6-D6
DIAMOND ST.	G6
DRIFTWOOD AVE.	D6
EAGLE ST.	D6
ECHO AVE.	D6
EMERALD AVE.	G5-G6
ESPLANADE AVE.	D4-D6
FERN PL.	E5
HADWAY DR.	G5-G6
HOPE PL.	H6
HOT SPRINGS RD.	I5-D5
JUNIPER PL.	E6
LAKBERG CRES.	F6
LILLOOET AVE.	D4-D6
MAPLE ST.	D5
MCCOMBS DR.	I6-E6
MCPHERSON RD.	I5-I6
MIAMI RIVER DR.	D5-E6
MOUNT ST.	D6
MYNG CRES.	H6-G6
NAISMITH AVE.	D6
PINE AVE.	F5-F6
POPLAR ST.	D5-E5
RAMONA PL.	G5
ROCKWELL DR.	C6-B6
SPRUCE ST.	D6
SLALICE ST.	D4
WALNUT AVE.	E5-E6

VILLAGE OF
HARRISON HOT
SPRINGS

★ FIRE HALL LOCATIONS

NOT TO SCALE